

HLSB SERIES-HG 2-3935

EAN 8422202239354



Castors with steel centre and black rubber tyre. Especially indicated to support high-loads up to 750 Kg. using a bracket with highly resistant spring loaded suspension to absorb impacts, collisions and uneven floors. Elastic behaviour of the spring up to 25mm, ideal in uneven surfaces due to its shock absorption. It is used in: logistics transport tools, outdoor areas, internal logistics, mobile platforms, elevating platforms, transport carts, logistics for military missions material, heavy machinery in the construction sector and mobile cranes. Mainly used in the aeronautic sector, railway and automobile factories.

HG: castor suitable for mechanical traction. High protection of floors. Smooth and noiseless tread. Absorption to impacts and vibrations

Technical Data

Housing Type	Swivel
Fitting Type	Plate
Braking System	Wheel Brake
Material	Rubber
Bearing	Ball
Diameter (mm)	200
Width of tyre (mm)	50
Plate dimensions (mm)	150x110
Distance between holes (mm)	105x80
Plate hole diameter (mm)	10
Offset (mm)	200
Overall height (mm)	265
Load	600

CAD

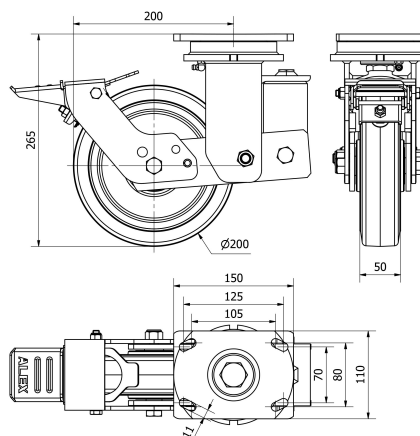

To visualize the image with higher resolution and more technical details, please access to the CAD section

Brackets



Similar products



Wheel



Rubber tyre on cast iron centre with grease nipple
Temperature range: -20° ÷ +60°

Rolling Resistance	Reasonable
Noise during the march	Excelent
Floor Protection	Excelent