

ZVI SERIES-PO 2-1410

EAN 8422202214108



Injected polyurethane castors with stainless steel (AISI 304) components. Especially indicated to support high-loads up to 600 Kg.

It is used in: outdoor areas, food trolleys, canteens, dining rooms, restaurants, food industry, logistics for military missions material, packaging machines, conveyor belts, stainless steel constructions, light machinery for the construction, containers, roll containers, transport cages, poultry farms, chemical industry, bakery machines, food chains, fridges, freezer cabinets and freezers.

Suitable for mechanical engineering projects by draftsmen and project executors.

PO: elastic functioning. Noiseless. High floor protection. Long useful life. High resistance to oils and grease. Clean and undeformable.

Technical Data

Housing Type	Swivel
Fitting Type	Bolt hole
Braking System	Without Brake
Material	Polyurethane
Hardness of tread	90-95° SHORE A
Bearing	Plain
Diameter (mm)	150
Width of tyre (mm)	42
Plate hole diameter (mm)	12
Offset (mm)	128
Overall height (mm)	190
Load	300
Unit Weight of the wheel (kg)	1.525
Volume (cm ³)	3196

CAD

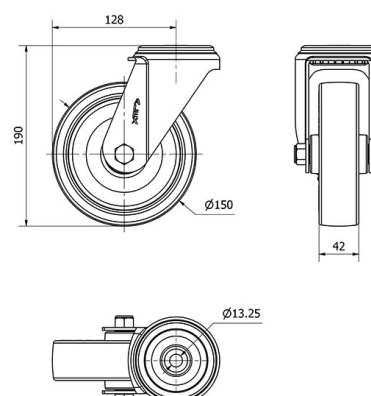

To visualize the image with higher resolution and more technical details, please access to the CAD section

Brackets

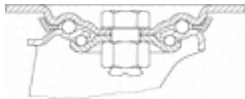

Made of high-quality pressed stainless steel (AISI 304) up to 3 mm. Bracket made completely of stainless steel, corrosion-free, resistant to petrol, diesel,oils and grease. Manufactured to European standards EN 12530/12532.

Similar products



2-1658

Wheel



Red polyurethane tyre on white polyamide centre.95° shore A
Temperature range: -25° ÷ +80°

