

ZV SERIES-AUB 2-2526

EAN 842220225265



Castors with aluminium centre and cast polyurethane tyre with a hardness of 95° Shore A. Especially indicated to support high-loads up to 400 Kg.

It is used in: logistics transport tools, repair shops, tool trolleys, tubular carts, pneumatic factories, internal logistics, tool trolleys, transport tools, elevating platforms, transport carts, ladders, sweeping machines, polishing machines, packaging machines, conveyor belts, mobile cranes, elevating driven carts, boilers, cabinetmaker's, metalworks, agricultural farms, elevating tables, meat industry, containers and sport centres.

Mainly used in the aeronautic sector, railway, automobile factories, food industry, repair shops and industrial activities.

Suitable for mechanical engineering projects by draftsmen and project executors.

AUB: polyurethane for heavy duty works. Absorption to impacts.

Technical Data

Housing Type	Swivel
Fitting Type	Plate
Braking System	Without Brake
Material	Polyurethane
Hardness of tread	95° SHORE A
Bearing	Ball
Diameter (mm)	100
Width of tyre (mm)	38
Plate dimensions (mm)	106x86
Distance between holes (mm)	86/80x60
Plate hole diameter (mm)	8
Offset (mm)	95
Overall height (mm)	133
Load	200
Unit Weight of the wheel (kg)	1.002
Volume (cm ³)	1706

CAD

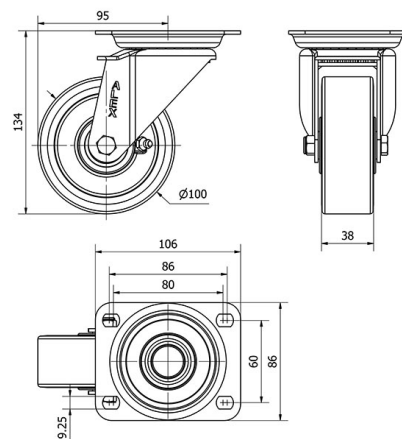

To visualize the image with higher resolution and more technical details, please access to the CAD section

Brackets

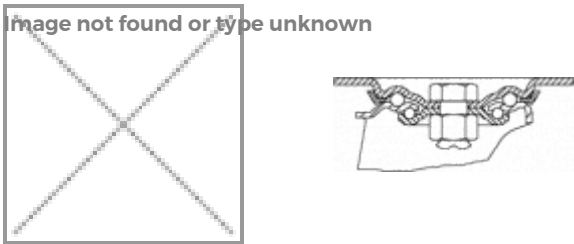

Made of pressed steel up to 4 mm. Finish: zinc plated finish. Double ball bearing in the swivel head. Universal model for medium-duty loads. Manufactured to European standards EN 12530/12532.

Similar products



Wheel



Polyurethane tyre on aluminium die-cast centre. 95° shore A
Temperature range: -20° ÷ +60°

