

ZV SERIES-BS 2-0225

EAN 8422202202259



Castors with metal centre and black rubber tyre. Especially indicated to support high-loads up to 250 Kg.

It is used in tool trolleys, tubular carts, internal logistics, mobile platforms, transport tools, elevating platforms, repair shops, logistics for military missions material, restaurants, sweeping machines, polishing machines, welding, cement mixers, mobile cranes, trailers, agricultural farms, elevating tables, roll containers and containers.

BS: smooth and noiseless castors. High floor protection. Absorption to impacts and vibrations.

Technical Data

Housing Type	Swivel
Fitting Type	Plate
Braking System	Without Brake
Material	Rubber
Bearing	Roller
Diameter (mm)	100
Width of tyre (mm)	27
Plate dimensions (mm)	106x86
Distance between holes (mm)	86/80x60
Plate hole diameter (mm)	8
Offset (mm)	95
Overall height (mm)	133
Load	110
Unit Weight of the wheel (kg)	0.975
Volume (cm ³)	1706

CAD

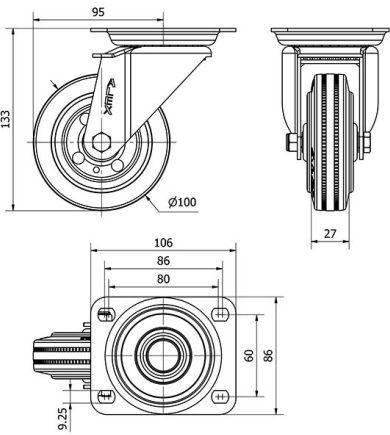

To visualize the image with higher resolution and more technical details, please access to the CAD section

Brackets

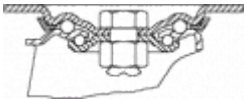

Made of pressed steel up to 4 mm.Finish: zinc plated finish.Double ball bearing in the swivel head.Universal model for medium-duty loads.Manufactured to European standards EN 12530/12532.

Similar products



2-0226



2-1149

Wheel



Rubber tyre on pressed steel centre
Temperature range: -20° ÷ +60°

Rolling Resistance	Reasonable
Noise during the march	Excelent
Floor Protection	Excelent