

ZV SERIES-POA 2-4073

EAN 8422202240732



Castors with white polypropylene centre and soft blue injected polyurethane tyre with a hardness of 80° Shore A. Especially indicated to support high-loads up to 250 Kg.

It is used in: logistics transport tools, repair shops, outdoor areas, internal logistics, tool trolleys, tubular carts, pneumatic factories, internal logistics, tranport tools, elevating platforms, transport carts, ladders, sweeping machines, polishing machines, packaging machines, conveyor belts, mobile cranes, elevating driven carts, boilers, cabinetmaker's, metalworks, agricultural farms, elevating tables, meat industry, containers and sport centres.

Mainly used in the aeronautic sector, railway, automobile factories, food industry, reappear shops and industrial activities.

Suitable for mechanical engineering projects by draftsmen and project executors.

POA: quieter rolling and vibrations absorption, clean and elastic. Very good wear resistance. Great resistance to oils.

Technical Data

Housing Type	Swivel
Fitting Type	Bolt hole
Braking System	Without Brake
Material	Polyurethane
Hardness of tread	80° SHORE A
Bearing	Plain
Diameter (mm)	80
Width of tyre (mm)	32
Plate hole diameter (mm)	12
Offset (mm)	77
Overall height (mm)	104
Load	100

CAD

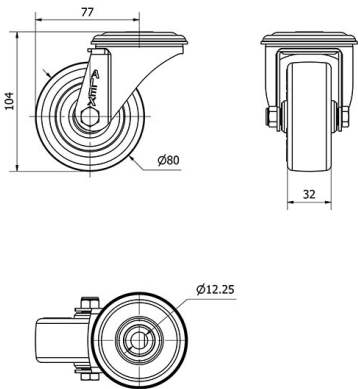

To visualize the image with higher resolution and more technical details, please access to the CAD section

Brackets

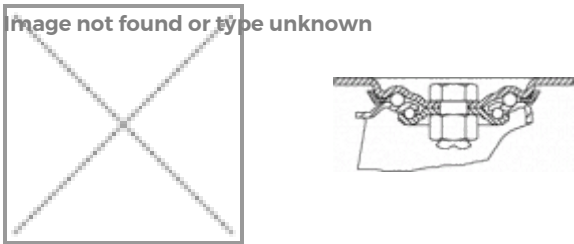

Made of pressed steel up to 4 mm. Finish: zinc plated finish. Double ball bearing in the swivel head. Universal model for medium-duty loads. Manufactured to European standards EN 12530/12532.

Similar products



Wheel



Blue soft polyurethane tyre on white polypropylene centre. 80° shore A
Temperature range: -25° ÷ +80°

